



# MANTONS

ESTATE AGENTS

## 1 Bedroom Studio for Rent - £575 per month

Burfield Court, Handcross Road, Luton, Bedfordshire, LU2 8JY



### KEY FEATURES:

- IMMACULATE STUDIO APARTMENT • RECENTLY REFURBISHED THROUGHOUT • AVAILABLE TO RENT FROM MIDDLE OF OCTOBER • DECORATED TO A CONTEMPORARY THEME • POSITIONED ON THE TOP FLOOR • ALLOCATED PARKING BAY • WALKING DISTANCE TO LOCAL SHOPS & SCHOOL • EASY ACCESS TO JUNCTION 10 OF THE M1

## Description

MANTONS LETTINGS are pleased to offer for rent this very impressive top floor studio apartment located in the popular area of Stopsley. The property is available to move into from the middle of October & has recently been refurbished through-out including; New carpets, decorated to a contemporary theme, replacement kitchen & bathroom.

In brief the property comprises; Communal entrance hall with stairs rising to the top floor, entrance lobby, refitted bathroom suite, open-plan living room/bedroom/kitchen.

Further benefits include; Double glazed windows & allocated parking bay.

Viewings come recommended to fully appreciate the condition & feel this property has to offer.

## ADDITIONAL INFORMATION

EPC Rating F

Council Tax Band A

Available to rent from 11th October

Deposit £663 (5 weeks rent)

Holding deposit £132 (1 weeks rent)

Part furnished

Client Money Protect Scheme (CMP) member number CMP005252

The Property Ombudsman (TPO) member number D12281

Positioned in the very sought after Stopsley area, Burfield Court was constructed in the 1970's. London Luton airport, junction 10 of the M1 motorway and Luton parkway Thames link train station are all within easy reach. 'Asda' supermarket is a short drive whilst the primary school 'Somerley' and high school 'Putteridge' are both within walking distance.



## Ground Floor

Approx. 30.8 sq. metres (331.0 sq. feet)

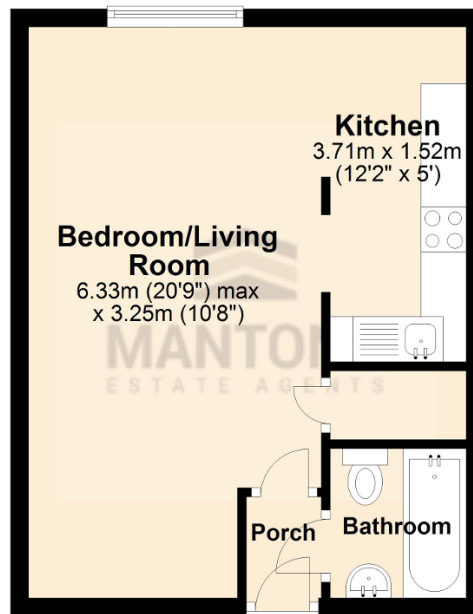

Total area: approx. 30.8 sq. metres (331.0 sq. feet)