



MANTONS

ESTATE AGENTS

2 Bedroom End Terraced for Sale - £240,000

Turners Road South, Luton, Bedfordshire, LU2 0PH



KEY FEATURES:

- EXCEPTIONAL END OF TERRACE HOME
- TWO GENEROUS SIZE BEDROOMS
- STYLISH REFITTED KITCHEN & BATHROOM
- DECORATED TO A CONTEMPORARY THEME
- REPLACEMENT COMBINATION BOILER
- WALKING DISTANCE TO LUTON TRAIN STATION
- EASY ACCESS TO M1 & LUTON AIRPORT
- TWO RECEPTION ROOMS

Description

MANTONS ESTATE AGENTS are pleased to offer for sale this truly stunning two bedroom end of terrace home located in the popular 'Round Green' area of Luton. Ideal first time or investment purchase (£850 - £900 pcm).

Decorated to a contemporary theme through-out with a stylish refitted bathroom suite & kitchen, replacement combination boiler & two well proportioned reception rooms. An internal viewing is highly recommended to fully appreciate the size, condition & finish this property has to offer.

In brief the property comprises; Entrance porch, 11ft living room with a feature fire place & bay window, 11ft dining room with 'French' door leading to the rear garden, refitted kitchen with ample units & counter space leading through to a refitted bathroom suite. On the first floor are two generous size bedrooms both with feature fire places.

Further benefits include; Gas central heating serviced via a replacement combination boiler (installed 2015), secluded North/West facing rear garden with patio area & garden shed, double glazed windows & doors

For more information or to arrange a viewing contact Mantons Estate Agents.

Turners Road South is located within a short walk of 'Round Green' where you will find an array of convenience stores, food outlets, bus stops & public house. London Luton airport, junction 10 of the M1 motorway and Thames link train stations are all within easy reach. 'Asda' supermarket is a short drive whilst the Primary school 'Ramridge' and High school 'Putteridge' are both within walking distance.

Additional Information

EPC Rating D. Council Tax Band B. 689 sqft (Approx).



Ground Floor
Approx. 37.7 sq. metres (406.0 sq. feet)

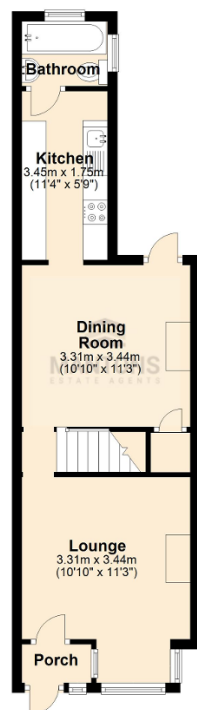

First Floor
Approx. 26.4 sq. metres (283.8 sq. feet)

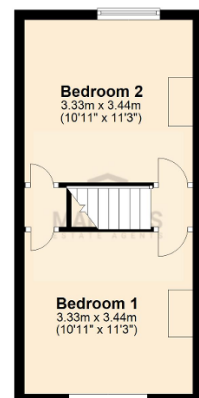

Total area: approx. 64.1 sq. metres (689.8 sq. feet)