



# MANTONS

ESTATE AGENTS

3 Bedroom Bungalow for Sale - Offers in Excess of £300,000

Cranbrook Drive, Luton, Bedfordshire, LU3 3EN



## KEY FEATURES:

- FULLY REFURBISHED SEMI DETACHED BUNGALOW
- NO UPPER CHAIN COMPLICATIONS
- DECORATED TO A CONTEMPORARY THEME
- REFITTED KITCHEN & BATHROOM
- GAS CENTRAL HEATING VIA A COMBI BOILER
- THREE GENEROUS SIZE BEDROOMS
- WALKING DISTANCE TO LOCAL SHOPS
- GARAGE WITH SHARED DRIVEWAY

## Description

MANTONS ESTATE AGENTS are pleased to offer for sale this completely refurbished three bedroom semi detached bungalow with no upper chain complications.

Over recent months the property has undertaken a substantial amount of work to provide a 'move in ready home'. Complete with a new central heating system, re-wired, re-plastered & a stylish kitchen & bathroom. Decorated to a contemporary theme with modern floor coverings.

In brief the property comprises; Entrance porch & hall, living room, fitted kitchen/breakfast room, bathroom suite & three well proportioned bedrooms.

Further benefits include; Double glazed windows & doors, gas central heating serviced via a combination boiler, loft access via ladder with light, garage with shared driveway and a West facing rear garden.

Contact Mantons Estate Agents to arrange a viewing or for more information.

Sundon Park is a popular residential area located in the North part of Luton, this particular property is positioned within walking distance is the main high street where you will find an abundance of local amenities including; Doctors, food outlets - Greggs, Subway, convenience stores, Tesco's express & pharmacy. Legrave Thames Link train station & M1 junction 11 & 11A are both within easy reach. Cheynes/Sundon Park Primary & Lealands High are the school catchments.

## Additional Information

EPC Rating D. Council Tax Band C. 758 sqft (Approx.)

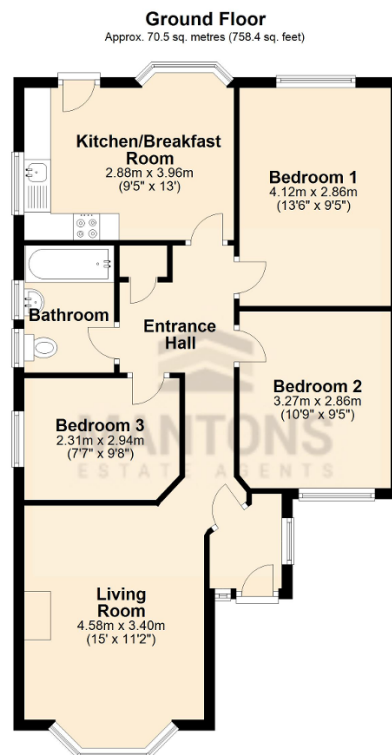

Total area: approx. 70.5 sq. metres (758.4 sq. feet)