



MANTONS

ESTATE AGENTS

2 Bedroom Terraced for Rent - £1,000 per month

Penda Close, Luton, Bedfordshire, LU3 3UU



KEY FEATURES:

- WELL PRESENTED TERRACE HOME • DECORATED TO A CONTEMPORARY THEME • AVAILABLE TO RENT IMMEDIATELY, £950 PCM • FITTED KITCHEN/DINER • 14FT LIVING ROOM & CONSERVATORY • SHOWER ROOM • ALLOCATED PARKING BAY • ALLOCATED PARKING BAY

Description

MANTONS LETTINGS are pleased to offer for rent this very impressive two bedroom terrace home located in Bramingham overlooking a small green, available to rent immediately.

Decorated to a contemporary theme throughout with a 'bright & airy' feel, replacement double glazing, conservatory & a private North/East facing rear garden.

In brief the property comprises; Entrance porch, 14ft living room with stairs rising to the first floor, fitted kitchen/diner leading through to the conservatory. On the first floor is a shower room & two well proportioned bedrooms.

Further benefits include; Allocated parking, rear garden with paved patio, electric heating & double glazed throughout.

Contact Mantons Lettings to arrange an internal viewing to fully appreciate the condition and attributes this property has to offer.

ADDITIONAL INFORMATION

EPC Rating E
Council Tax Band B
Available to rent immediately
Deposit £1096.00 (5 weeks rent)
Holding deposit £219.00 (1 weeks rent)
Unfurnished
Client Money Protect Scheme (CMP) member number CMP005252
The Property Ombudsman (TPO) member number D12281

Penda Close is located on the 'Bramingham' development in the North part of Luton. All local amenities are within walking distance including; Convenient stores, pharmacy, doctors and local bus routes. Leagrave Thames Link train station is 0.7 mile & junction 11 & 11a of the M1 are both within easy reach. Waulud Primary & Lea Manor High are the school catchments.



Ground Floor
Approx. 36.6 sq. metres (393.9 sq. feet)

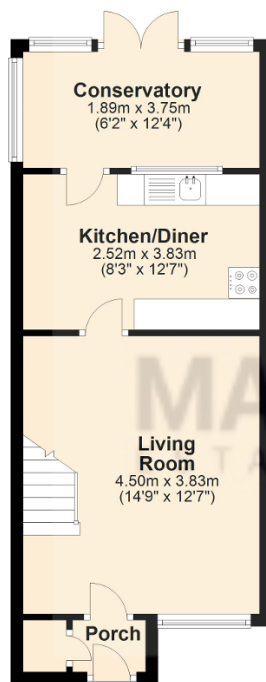

First Floor
Approx. 27.5 sq. metres (296.1 sq. feet)

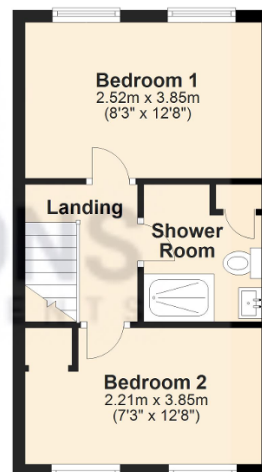

Total area: approx. 64.1 sq. metres (690.0 sq. feet)