



MANTONS

ESTATE AGENTS

2 Bedroom Terraced for Rent - £1,250 per month

Wiseman Close, Luton, Bedfordshire, LU2 7GE



KEY FEATURES:

- WELL PRESENTED TERRACE HOME • TWO GENEROUS SIZE BEDROOMS • AVAILABLE TO RENT IMMEDIATELY, £1250 PCM • DECORATED TO A CONTEMPORARY THEME • FITTED KITCHEN/DINER • MODERN BATHROOM SUITE • GAS CENTRAL HEATING VIA COMBI BOILER • WALKING DISTANCE TO OPEN COUNTRYSIDE

Description

MANTONS LETTINGS are pleased to offer for rent this very well presented two bedroom terrace home located in Bushmead, available to move into immediately.

Decorated throughout to a contemporary with neutral floor coverings, modern bathroom suite & gas central heating serviced via a newly installed combination boiler.

In brief the property comprises; Entrance porch, living room with with stairs rising to the first floor, spacious kitchen/diner fitted with gas hob, electric oven, extractor fan & fridge/freezer with patio door opening to the rear garden. Two double bedrooms both with built-in wardrobes & a modern bathroom suite occupy the first floor.

Further benefits include; Double glazed windows & doors, driveway to front, enclosed rear garden with paved patio, rear access & garden shed.

Contact Mantons Lettings for further information or to arrange a viewing.

ADDITIONAL INFORMATION

EPC Rating C
Council Tax Band C
Available to rent immediately
Deposit £1440.00 (5 weeks rent)
Holding deposit £288.00 (1 weeks rent)
Part furnished
Client Money Protect Scheme (CMP) member number CMP005252
The Property Ombudsman (TPO) member number D12281

Wiseman Close is a small close located in Bushmead, a very popular housing development constructed in the 1990's. Within walking distance is beautiful open countryside where you can enjoy scenic walks across Warden Hills. Local amenities including; Coop supermarket, chemist, restaurant, hairdressers, doctors & public house. A frequent bus service operates through the development whilst Luton ThamesLink train station is within 2 miles. Luton airport & junction 10 & 11 of the M1 motorway are all within easy reach. Warden Hill Primary & Stopsley/Icknield High are the school catchments.



Ground Floor
Approx. 26.6 sq. metres (286.4 sq. feet)

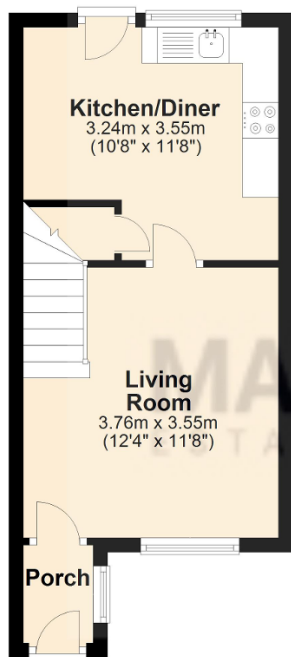

First Floor
Approx. 25.3 sq. metres (272.0 sq. feet)

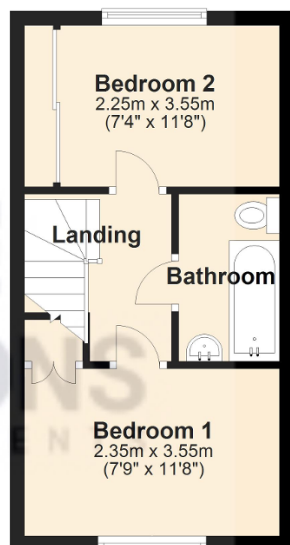

Total area: approx. 51.9 sq. metres (558.3 sq. feet)