



MANTONS

ESTATE AGENTS

2 Bedroom Maisonette for Rent - £950 per month

Green Oaks, Luton, Bedfordshire, LU2 7TH



KEY FEATURES:

- WELL APPOINTED FIRST FLOOR APARTMENT
- TWO GENEROUS SIZE BEDROOMS
- AVAILABLE FROM THE BEGINNING OF JUNE
- £950.00 PER MONTH RENT
- GAS CENTRAL HEATING & DOUBLE GLAZED
- ENCLOSED REAR GARDEN
- CUL DE SAC LOCATION
- FITTED KITCHEN WITH APPLIANCES

Description

MANTONS LETTINGS are pleased to offer for rent this very spacious & well presented two bedroom first floor maisonette located in Stopsley, available to move into from the beginning of June for £950.00 per month.

The property is decorated to a contemporary theme through-out with gas central heated & an enclosed rear garden.

In brief the property comprise; Entrance hall with stairs rising to the first floor, two well proportioned bedrooms, fitted kitchen & bathroom suite & spacious lounge/diner.

Further benefits include; Double glazed windows & resident parking.

Viewings come highly recommended on this impressive property. Contact Mantons Estate Agents for more information or to arrange a viewing.

ADDITIONAL INFORMATION

EPC Rating C
Council Tax Band A
Available to rent immediately
Deposit £1096.15 (5 weeks rent)
Holding deposit £219.23 (1 weeks rent)
Unfurnished - Kitchen appliances included
Client Money Protect Scheme (CMP) member number CMP005252
The Property Ombudsman (TPO) member number D12281

Green Oaks is a small close located in the popular area of 'Stopsley'. Positioned within walking distance to Stopsley village & Round Green where you will find an array of convenience stores, food outlets, bus stops, public house's, doctors, chemist and coffee shops. Junction 10 of the M1 motorway, Parkway Thames Link train station & London Luton airport are all within easy reach. Stopsley Primary & High are the school catchments.



First Floor

Approx. 49.3 sq. metres (530.2 sq. feet)

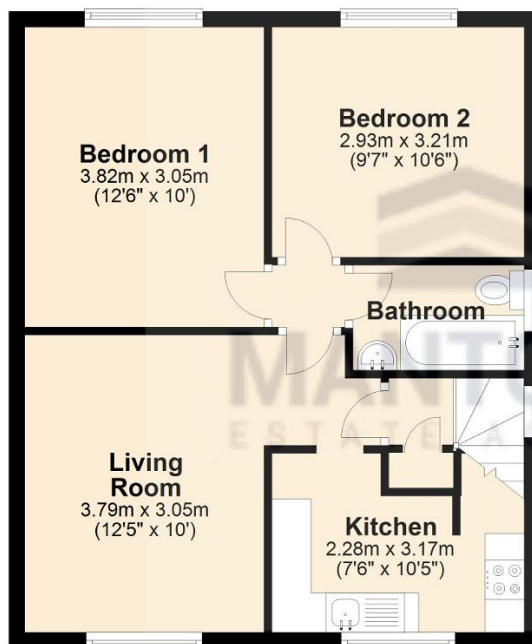

Ground Floor

Approx. 3.7 sq. metres (40.0 sq. feet)



Total area: approx. 53.0 sq. metres (570.2 sq. feet)