



MANTONS

ESTATE AGENTS

2 Bedroom Terraced for Rent - £1,250 per month

Lorimer Close, Luton, Bedfordshire, LU2 7RL



KEY FEATURES:

- WELL PRESENTED TWO BEDROOM HOME • AVAILABLE TO RENT IMMEDIATELY - £1250 • DECORATED TO A CONTEMPORARY THEME • POPULAR BUSHMEAD DEVELOPMENT • RECENTLY LANDSCAPED REAR GARDEN • MODERN KITCHEN WITH APPLIANCES • WALKING DISTANCE TO OPEN COUNTRYSIDE • PARKING TO FRONT

Description

MANTONS LETTINGS are pleased to bring to market this well presented two bedroom terrace home nestled in a cul de sac on the popular Bushmead development. Available to move into immediately for £1250.00 per month.

Recently decorated throughout to a contemporary theme with neutral floor coverings, modern kitchen with appliances & a stylish bathroom suite.

12ft living room with patio doors opening to the rear garden & a recently landscaped rear garden with timber decking & artificial lawn are just a couple of the attributes this property has to offer.

In brief the property comprises; Entrance hall with stairs rising to the first floor, fitted kitchen with washing machine, fridge/freezer, oven & hob, 12ft living room with patio doors leading to the rear garden. On the first floor is a stylish refitted bathroom suite & two well proportioned bedrooms.

Further benefits include; Gas central heating serviced via a replacement boiler, allocated parking bay to front & double glazed windows & doors.

For further information or to arrange a viewing contact Mantons Estate Agents.

ADDITIONAL INFORMATION

EPC Rating C

Council Tax Band C

Available to rent immediately

Deposit £1442.00 (5 weeks rent)

Holding deposit £288.00 (1 weeks rent)

Unfurnished - Kitchen appliances included

Client Money Protect Scheme (CMP) member number CMP005252

The Property Ombudsman (TPO) member number D12281

Lorimer Close is a very pleasant road located on the popular Bushmead development, constructed in the 1990's. This particular property is positioned in a cul de sac, within a stones throw of beautiful open countryside; Warden Hills. Local shops, doctors, chemist, public house & bus route are all within easy reach. Bushmead/Warden Hill Primary & Stopsley High are the school catchments.



Ground Floor

Approx. 24.7 sq. metres (266.4 sq. feet)

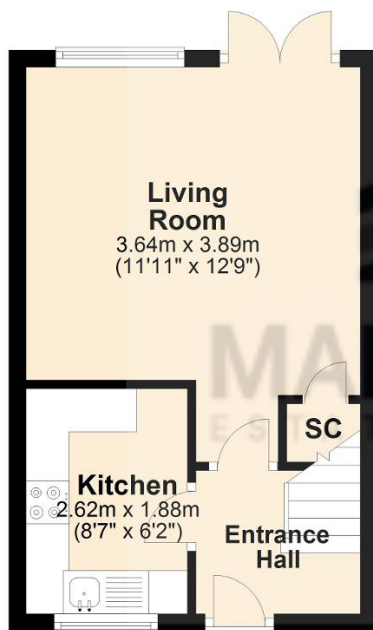

First Floor

Approx. 24.7 sq. metres (265.9 sq. feet)

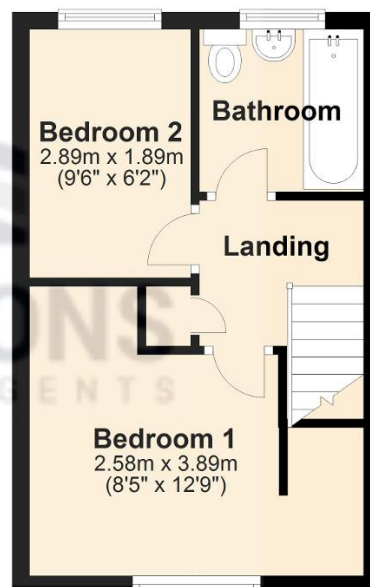

Total area: approx. 49.5 sq. metres (532.3 sq. feet)