



# MANTONS

ESTATE AGENTS

3 Bedroom Terraced for Rent - £1,500 per month

Fieldfare Green, Luton, Bedfordshire, LU4 0YA



## KEY FEATURES:

- WELL PRESENTED THREE BEDROOM HOME
- AVAILABLE TO RENT IMMEDIATELY, £1500 PCM
- DECORATED TO A CONTEMPORARY THEME
- NEWLY LAID CARPETS
- SECLUDED SOUTH/EAST FACING REAR GARDEN
- GARAGE WITH DRIVEWAY
- FITTED KITCHEN & BATHROOM
- EASY ACCESS TO M1 JUNCTION 11 & 11A

## Description

MANTONS LETTINGS are pleased to offer for rent this well presented three bedroom terrace home located on the popular 'Birds' development, available to move into immediately for £1500 per month.

Decorated to a contemporary theme throughout with a 'bright & airy' feel, gas central heating serviced via a replacement boiler & newly laid carpets.

In brief the property comprises; Entrance hall with stairs rising to the first floor, 23ft lounge/diner & fitted kitchen. On the first floor is a bathroom suite & three bedrooms.

Further benefits include; Double glazed windows & doors, garage with driveway, front garden, private South/East facing rear garden with artificial lawn, garden sheds & rear access leading to the garage.

Contact Mantons Lettings for more information or to arrange a viewing.

## ADDITIONAL INFORMATION

EPC Rating B  
Council Tax Band C  
Available to rent immediately  
Deposit £1730 (5 weeks rent)  
Holding deposit £346 (1 weeks rent)  
Unfurnished  
Client Money Protect Scheme (CMP) member number CMP005252  
The Property Ombudsman (TPO) member number D12281

Fieldfare Green is a select close within the popular 'Birds' development, situated on the outskirts of Luton, en route to Dunstable & Houghton Regis. It's conveniently located near Junction 11 & 11a of the M1 motorway and just a short drive from Leagrave ThamesLink train station. Additionally, the Luton & Dunstable Hospital is within walking distance.

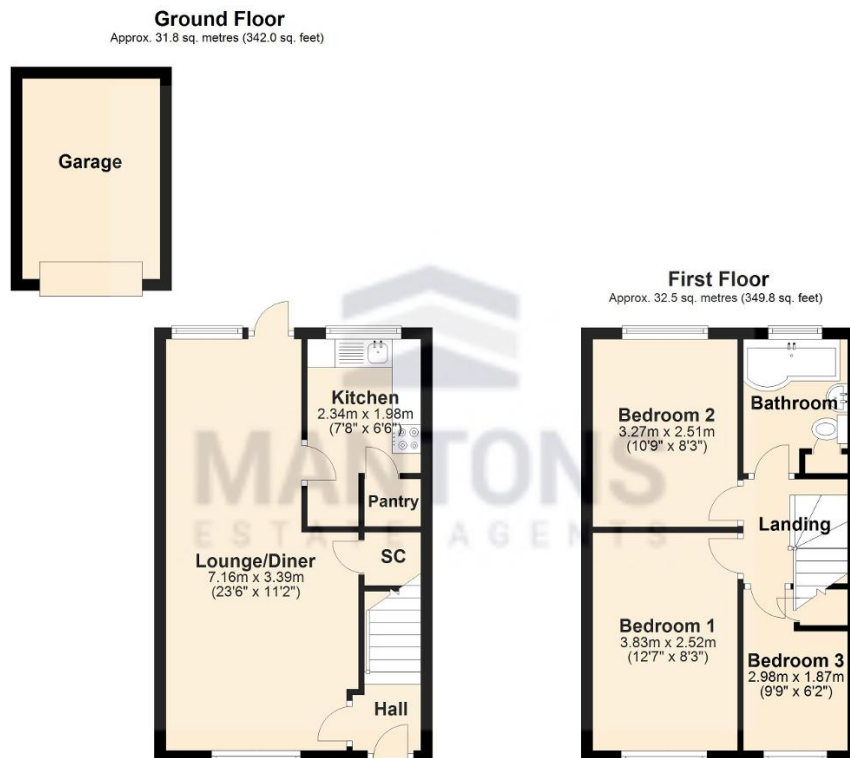

Total area: approx. 64.3 sq. metres (691.8 sq. feet)