



MANTONS

ESTATE AGENTS

2 Bedroom End Terraced for Sale - £300,000

Catesby Green, Luton, Bedfordshire, LU3 4DR



KEY FEATURES:

- IMMACULATE END OF TERRACE HOME • TWO GENEROUS SIZE BEDROOMS • DECORATED TO A CONTEMPORARY THEME • MODERN KITCHEN & BATHROOM • SOUGHT AFTER BARTON HILLS AREA • GARAGE IN NEARBY BLOCK • WALKING DISTANCE TO SAINSBURY'S • BLOCK PAVED DRIVEWAY

Description

Mantons Estate Agents are delighted to present for sale this impressive two bedroom end of terrace home located in the popular Barton Hills development.

The property features contemporary decor throughout, ideal first time purchase or buy-to-let investment (£1250pcm Approx.). Block paved driveway & garage in a nearby block, modern kitchen & bathroom.

The home includes an entrance porch, 14ft living room with stairs leading to the first floor, separate dining room, fitted kitchen with door leading to a well maintained rear garden, two double bedrooms & a fitted bathroom suite.

Additional benefits include double glazed windows & doors, gas central heating, fitted wardrobes in the master bedroom, a low maintenance rear garden with a patio area, gated side access & lawn.

For more information or to arrange a viewing, contact Manton's Estate Agents.

Catesby Green is situated in Barton Hills, a highly sought-after housing development built in the early 1990s. This area remains as popular today as when it was first established. Residents enjoy convenient access to various local amenities, including Sainsbury's & Aldi supermarkets, doctors, Costa coffee shop, dentist, a public house & local bus routes. The development falls within the catchment areas for Warden Hill Primary & Lea Manor High schools.

Additional Information

EPC Rating TBC. Council Tax Band C. 688 sqft (Approx).



Ground Floor

Approx. 33.8 sq. metres (363.7 sq. feet)

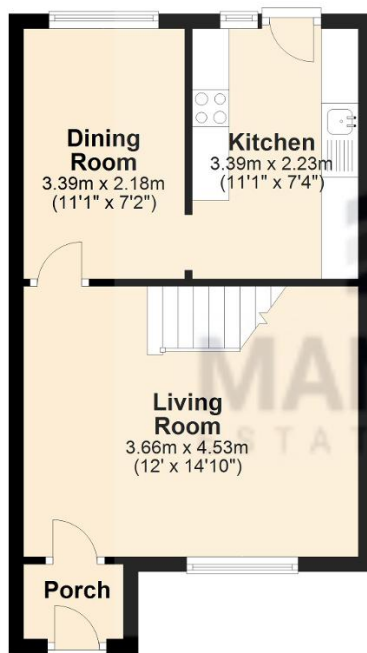

First Floor

Approx. 30.1 sq. metres (324.3 sq. feet)

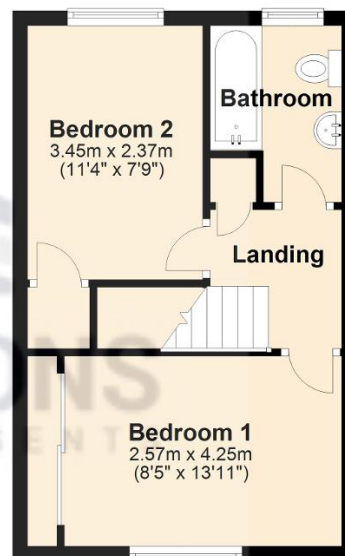

Total area: approx. 63.9 sq. metres (688.0 sq. feet)