



MANTONS

ESTATE AGENTS

1 Bedroom Park Home for Rent - £775 per month

Castle Hill Road, Totternhoe, Dunstable, LU6 1QH



KEY FEATURES:

- WELL PRESENTED ONE BEDROOM PARK HOME • AVAILABLE TO RENT IMMEDIATELY - £775 • RESIDENTS TO BE 45 YEARS OF AGE OR ABOVE • FITTED KITCHEN & BATHROOM • GAS CENTRAL HEATING VIA A COMBI BOILER • RESIDENT PARKING • GAS CENTRAL HEATING VIA A COMBI BOILER • 13FT LIVING ROOM

Description

MANTONS LETTINGS are pleased to offer for rent this well presented one bedroom park home located in the quaint village of Totternhoe.

Neutral floor coverings & contemporary décor, perfect to move straight into.

The property is available to rent immediately for £775.00 per month. All residents must be 45 years of age or above with no children or pets.

In brief the property comprises; Entrance hall, double bedroom with wardrobes, modern bathroom, fitted kitchen with appliances & a 13ft living room.

Further benefits include; Double glazed windows & doors, gas central heating serviced via a combination boiler (LPG), lawn area with garden shed & resident parking.

Viewings come recommended to fully appreciate the condition & feel this property has to offer.

ADDITIONAL INFORMATION

Council Tax Band A

Available to rent immediately

Deposit £890.00 (5 weeks rent)

Holding deposit £178.00p (1 weeks rent)

Part furnished - White goods & wardrobes

Client Money Protect Scheme (CMP) member number CMP005252

The Property Ombudsman (TPO) member number D12281

Poplar Farm Park is located in the quaint village of Totternhoe which sits just outside to town of Dunstable. Totternhoe has easy access to the A5 for the M1 & A41 for the M25.



Ground Floor

Approx. 32.4 sq. metres (349.0 sq. feet)

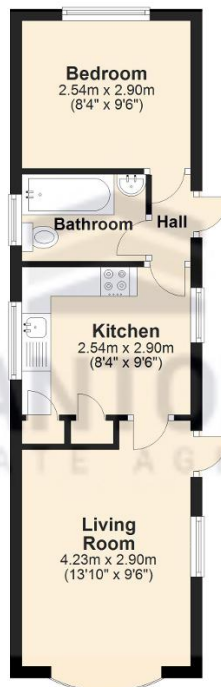

Total area: approx. 32.4 sq. metres (349.0 sq. feet)