



MANTONS

ESTATE AGENTS

1 Bedroom End Terraced for Sale - £225,000

Elveden Close, Luton, Bedfordshire, LU2 7FF



KEY FEATURES:

- EXCEPTIONAL ONE BEDROOM END OF TERRACE • NO UPPER CHAIN COMPLICATIONS • RARELY AVAILABLE TO THE MARKET • ENCLOSED WEST FACING REAR GARDEN • DRIVEWAY TO REAR • GAS CENTRAL HEATING VIA A COMBI BOILER • NEWLY INSTALLED CARPETS • WALKING DISTANCE TO OPEN COUNTRYSIDE

Description

MANTONS ESTATE AGENTS are pleased to offer for sale this very impressive one bedroom end-of-terrace home, located on the popular 'Bushmead' development in North Luton & available with no upper chain complications.

This unique style of property is rarely available, with only a limited number constructed on the development. Early viewing is strongly recommended to avoid disappointment.

Beautifully presented with a contemporary theme, the home offers a bright & airy atmosphere throughout. Key features include gas central heating serviced by a combination boiler, newly fitted carpets & a secluded West facing rear garden, just a few of the many appealing aspects of this immaculate home.

The accommodation comprises an entrance porch, a spacious living room, fitted kitchen with access to the rear garden, bathroom suite & a bedroom. Additional benefits include fitted wardrobes located on the landing, a driveway to the rear of the property, replacement double glazed windows & a low maintenance rear garden with gated side access.

For further information or to arrange a viewing, please contact Mantons Estate Agents.

Elveden Close is a small close located in Bushmead, a very popular housing development constructed in the 1990's. Within walking distance is beautiful open countryside where you can enjoy scenic walks across Warden Hills. Local amenities including; Coop supermarket, chemist, restaurant, hairdressers, doctors & public house. A frequent bus service operates through the development whilst LutonThames Link train station is within 2 miles. Luton airport & junction 10 & 11 of the M1 motorway are all within easy reach. Bushmead/Warden Hill Primary & Icknield High are the school catchments.

Additional Information

EPC Rating C. Council Tax Band B. 447 Sq.ft (Approx.).



Ground Floor

Approx. 21.7 sq. metres (233.6 sq. feet)

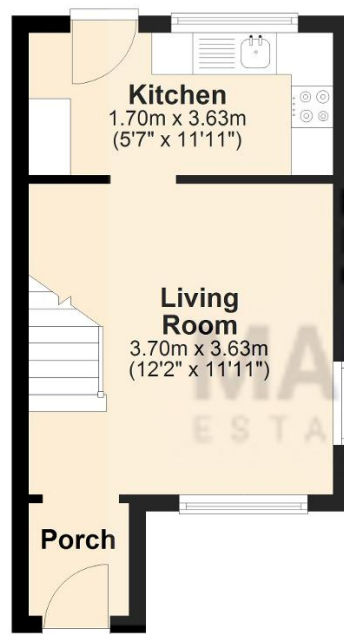

First Floor

Approx. 19.9 sq. metres (213.7 sq. feet)

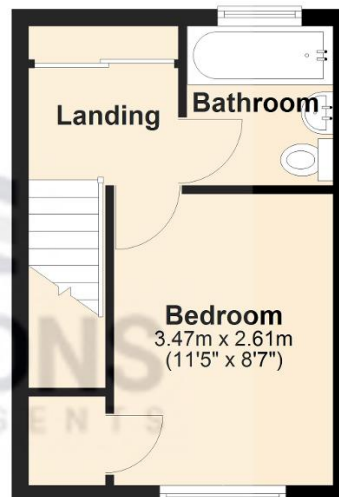

Total area: approx. 41.6 sq. metres (447.3 sq. feet)